



NVF6
26×26×22.7



NVF6-2
26×26×22.7(+15.2)



NVF6-2b
35.5×35.5×45.5(+22.5)

NVF6

Features

- Heavy contact load (50A).
- 1 Form A and 1 Form C configurations .
- Dust cover and washable type are available.
- PC board mounting and direct insert mounting available.
- Widely operated in automobile lamps, Rear-window defroster, air-conditioner, open circuit, fuel pump, cooling fan ,on-off control, etc.

Ordering Information

NVF6 C Z 50 a R DC12V
1 2 3 4 5 6 7

1 Part number: NVF6, NVF6-2(Insulation Bracket) NVF6-2a(With Metal Bracket) NVF6-2b(Shrouded Type With Metal Bracket)	6 Coil transient suppression: D: with diode; R: with resistor; NIL: standard
2 Contact arrangement: A:1A;C:1C	7 Coil rated voltage(V):DC:12,24
3 Enclosure: S: Wash tight type; Z: Flux proof type;	
4 Contact current: 50A	
5 Terminals: a: Plug in type; b:PCB type	

Contact Data

Contact Arrangement	1A(1H) (SPSTNO) ,1C(1Z) (SPDT(B-M))	
Contact Material	AgSnO Alloy	
Contact Rating (Resistive)	1A	1C
	50A/14VDC 20A/28VDC	NO:50A/14VDC,20A/28VDC NC:30A/14VDC,15A/28VDC
Max. Switching Power	700W	
Max. Switching Voltage	120VDC	Max. Switching Current: 50A
Voltage Drop	≤ 50mV(at 10A)	Item 4.12 of IEC 61810-7
Operation life	Electrical	10 ⁵ Item 4 .30 of IEC 61810-7
	Mechanical	10 ⁷ Item 4 .31 of IEC 61810-7

Coil Parameter

Dash numbers	Coil voltage VDC		Coil resistance Ω ±10%		Pick-up voltage VDC(max)	Release voltage VDC(min)	Coil power consumption (W)		Operate Time ms	Release Time ms
	Rated	Max.	Without resistor	With resistor			Without resistor	With resistor		
012-1600	12	15.6	90	80	65%of rated voltage	10%of rated voltage	Approx. 1.6	Approx. 1.8	≤10	≤10
024-1600	24	31.2	360	320						

CAUTION: 1.The use of any coil voltage less than the rated coil voltage will compromise the operation of the relay.
2.Pickup and release voltage are for test purposes only and are not to be used as design criteria.

Operation condition

Insulation Resistance	100M Ω min (at 500VDC)	Item 4.11 of IEC 61810-7
Dielectric Strength Between open contacts Between contact and coil	50~60Hz AC500V 1min 50~60Hz AC500V 1min	Item 4.9 of IEC 61810-7 Item 4.9 of IEC 61810-7
Shock resistance	294m/s ²	Item 4.26 of IEC 61810-7
Vibration resistance	10~22.30Hz double amplitude 10mm 22.3~500Hz 98m/s ²	Item 4.28 of IEC 61810-7
Terminals strength	Terminal retention(pull & push): \geq 100N Terminal resistance to bending(front & side): \geq 10N	Item 4.24 of IEC 61810-7
Ambient Temperature	-40 $^{\circ}$ C~125 $^{\circ}$ C	
Relative Humidity	85% (at 40 $^{\circ}$ C)	Item 4.16 of IEC 61810-7
Mass	35g	Item 4.7 of IEC 61810-7

Note: 1). When testing, coil terminals should be connected, If coil transient suppression is installed in relay .

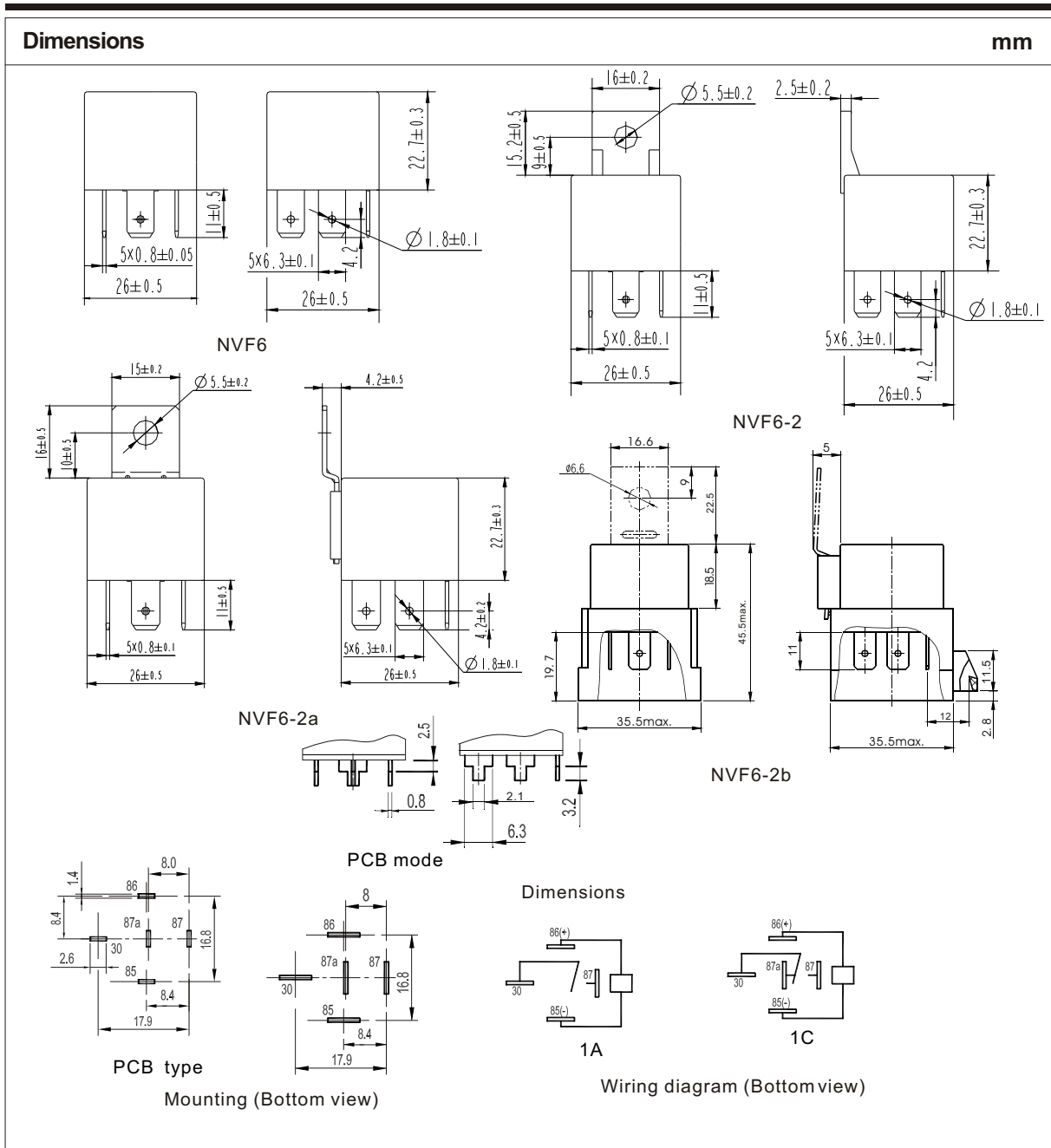

Reference Date

