

60×40×22

NE720

 13002098871

Features

- Latching relay.
- High sensitivity & reliability.
- Well anti-shock and anti-vibration.
- Heavy contact load.

Ordering Information

NE720 **A** **Z** **D** **DC12V**
 1 2 3 4 5

1 Part number: NE720

2 Contact arrangement: A:1A; B:1B

3 Enclosure: Z: Dust cover

4 Coil: Nil :Single coil ; D: Double coils

5 Coil rated voltage(V): DC:6,12, 24,48

Contact Data

Contact Arrangement	1A(SPSTNO) 1B(SPSTNC)	
Contact Material	AgSnO ₂	
Contact Rating(Resistive)	100A _{max} /240VAC	
Max. Switching Power	23000VA(COSΦ=1) 2300VA(COSΦ=0.4)	
Max. Switching Voltage	400VAC	Max. Switching Current:100A
Contact Resistance	≤1mΩ	Item 4.12 of IEC 61810-7
Operation Life	Electrical (Rated Load)	1×10 ⁴ Item 4.30 of IEC 61810-7
	Mechanical (No Load)	1×10 ⁶ Item 4.31 of IEC 61810-7

Coil Parameter

Dash numbers	Rated voltage VDC	Coil resistance Ω ±10%	Set/Reset voltage VDC (<80% of rated voltage)	Operating voltage range VDC	Pulse duration ms	Coil power W	Set time ms	Reset time ms
2 Coils								
006-4500	6	2×8	<4.8	6~10	≥36	2×4.5	≤12	≤6
012-4500	12	2×32	<9.6	12~20				
024-4500	24	2×130	<19.2	24~40				
048-4500	48	2×512	<38.4	48~80				
1 Coil								
006-2250	6	16	<4.8	6~10	≥36	2.25	≤12	≤6
012-2250	12	64	<9.6	12~20				
024-2250	24	260	<19.2	24~40				
048-2250	48	1024	<38.4	48~80				

CAUTION: 1.When latching relays are installed in equipment, the latch and reset coil should not be powered simultaneously. Coil should not be pulsed with less than the nominal coil voltage and pulse width should be a minimum of three times the specified operate time of the relay. If these conditions are not followed, it is possible for the relay to in be the magnetically neutral position .
 2.Switching voltage is for test purpose only and are no to be used as design criteria.

Characteristics

Insulation Resistance	1000M Ω min (at 500VDC)	Item 4.11 of IEC 61810-7
Dielectric Strength Between Contacts Between Contact and Coil	50Hz 2000V Surge Voltage 4kV 50Hz 4000V Surge Voltage 12kV	Item 4.9 of IEC 61810-7 Item 4.9 of IEC 61810-7
Creepage Distance	8.4mm	
Shock Resistance	Functional:98m/s ² ;Destructive:980 m/s ² 11ms	Item 4.26 of IEC 61810-7
Vibration Resistance	10Hz~55Hz Double amplitude 1.5mm	Item 4.28 of IEC 61810-7
Terminals Strength	5N; 2.5N	Item 4.24 of IEC 61810-7
Ambient Temperature	-40 $^{\circ}$ C~85 $^{\circ}$ C	
Relative Humidity	5% to 85%	Item 4.16 of IEC 61810-7
Mass	82g	Item 4.7 of IEC 61810-7

Safety Approvals

Safety approval	CQC
Load	100A/220VAC

Dimensions

mm

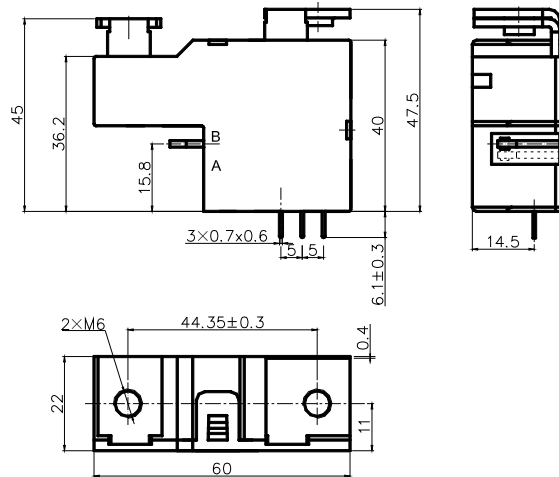

Dimensions

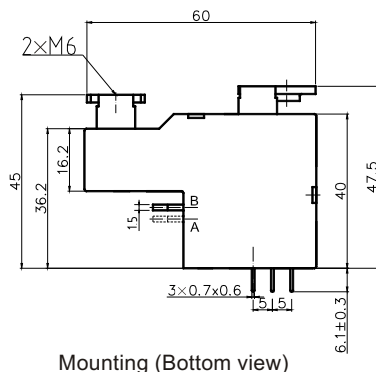

Mounting (Bottom view)

Notes: A:NC side
B:NO side

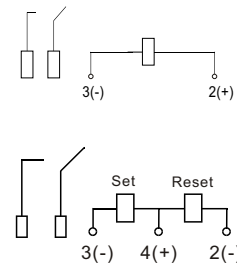

Wiring diagram

CAUTION: 1.Relays shall have plus(+) signs or “+” and “-” placed on the circuit diagram as shown.

2.In case of no tolerance shown in outline dimension: outline dimension ≤ 1 mm, tolerance should be ± 0.2 mm;
outline dimension > 1 mm and ≤ 5 mm, tolerance should be ± 0.3 mm; outline dimension > 5 mm, tolerance should be ± 0.4 mm.