



30.5×16.1×23.7

JQX- 102F

 E158859

Features

- 25A switching capability.
- PC board mounting and QC mounting available.
- Dielectric strength of 4500 V between coil and contacts.
- Used in household appliances like air conditioning , heater and instruments etc.

Ordering Information

JQX-102F A Z DC12V C 0.9
1 2 3 4 5 6

1 Part number: JQX-102F
2 Contact arrangement: A:1A
3 Enclosure: Z: Flux proof ; S: Wash tight

4 Coil rated voltage(V): DC:5,12,24,48
5 Contact material: Nil:AgSnO₂; C:AgCdO
6 Coil power: 0.9:0.9W

Contact Data

Contact Arrangement	1A(SPSTNO)	
Contact Material	AgSnO ₂ AgCdO	
Contact Rating	20A,25A/250VAC; 25A/277VAC Motor load: 2HP 240VAC	
Max. Switching Power	6925VA	
Max. Switching Voltage	277VAC	Max. Switching Current:25A
Contact Resistance	≤100mΩ (at 1A/24VDC)	Item 4.12 of IEC 61810-7
Electrical Endurance	1×10 ⁵	Item 4.30 of IEC 61810-7
Mechanical Endurance	2×10 ⁶	Item 4.31 of IEC 61810-7

Coil Parameter

Dash numbers	Coil voltage VDC		Coil resistance Ω ± 10%	Pick-up voltage VDC(max) (70% of rated voltage)	Drop-out voltage VDC(min) (10% of rated voltage)	Coil power W	Operate time ms	Release time ms
	Rated	Max.						
005-900	5	6	27.8	3.75	0.5	0.9	≤20	≤10
012-900	12	14.4	160	9	1.2			
024-900	24	28.8	640	18	2.4			
048-500	48	57.6	2560	36	4.8			

Notes: 1. The use of any coil voltage less than the rated coil voltage will compromise the operation of the relay.
2. Pick-up and drop-out voltage are for test purposes only and are not to be used as design criteria.

Characteristics

Insulation Resistance	1000MΩ min (at 500VDC)	Item 4.11 of IEC 61810-7
Dielectric Strength Between Contacts Between Contact and Coil	1000VAC 1min 4500VAC 1min Surge voltage:10kV(1.2/50μs)	Item 4.9 of IEC 61810-7 Item 4.10 of IEC 61810-7
Shock Resistance	Functional:196m/s ² 11ms Destructive:980 m/s ² 11ms	Item 4.26 of IEC 61810-7
Vibration Resistance	10Hz~55Hz Double amplitude Functional:1.5mm Double amplitude Destructive:2.0mm	Item 4.28 of IEC 61810-7
Terminals Strength	10N	Item 4.24 of IEC 61810-7
Ambient Temperature	-40℃~85℃	
Relative Humidity	5% to 85%	Item 4.16 of IEC 61810-7
Weight (Approx.)	23g	Item 4.7 of IEC 61810-7

Safety Approvals

Safety approval	UL&CUR
Load	20A,25A/250VAC 85℃ 1×10 ⁵ 25A/277VAC 2HP 240VAC 85℃ 1×10 ⁵

Dimensions

mm

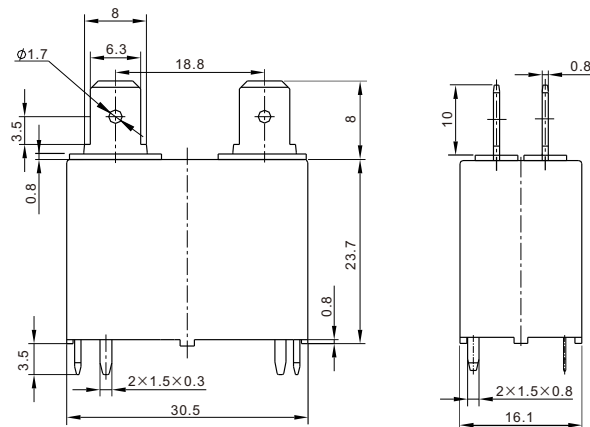
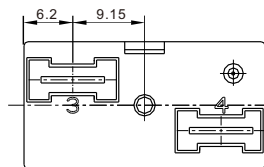

Dimensions

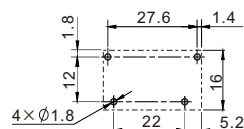

Mounting(Bottom view)

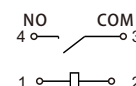

Wiring diagram(Bottom view)

Remark: In case of no tolerance shown in outline dimension: outline dimensions≤1mm,tolerance should be ±0.2mm ;
outline dimension >1mm and ≤5mm, tolerance should be ±0.3mm; outline dimension >5mm, tolerance should be ±0.4mm.