



20.5×15.4×22.1

NVF16

Features
<ul style="list-style-type: none"> General-purpose relay with small size. Small volume and light weight. Operation temperature can achieve 125°C. Contact rating: 35A and 40A versions are available.

Ordering Information		
<p><u>NVF16</u> <u>A</u> <u>Z</u> <u>35</u> <u>DC12V</u> <u>R</u></p> <p>1 2 3 4 5 6</p>		
<table border="0"> <tr> <td style="vertical-align: top;"> 1 Part number: NVF16 2 Contact arrangement: A:1A;C:1C 3 Enclosure: S: Wash tight; Z: Flux proof 4 Contact rating: 12V:1A:35A/14VDC;1C:NO:35A/14VDC;NC:20A/14VDC 1A:40A/14VDC(Special clients) 24V:1A:15A,20A/28VDC; 1C:NO:15A/28VDC; NC:10A/28VDC </td> <td style="vertical-align: top;"> 5 Coil rated voltage(V): DC:12,24 6 Coil transient suppression: NIL:standard R:with resistor D:with diode </td> </tr> </table>	1 Part number: NVF16 2 Contact arrangement: A:1A;C:1C 3 Enclosure: S: Wash tight; Z: Flux proof 4 Contact rating: 12V:1A:35A/14VDC;1C:NO:35A/14VDC;NC:20A/14VDC 1A:40A/14VDC(Special clients) 24V:1A:15A,20A/28VDC; 1C:NO:15A/28VDC; NC:10A/28VDC	5 Coil rated voltage(V): DC:12,24 6 Coil transient suppression: NIL:standard R:with resistor D:with diode
1 Part number: NVF16 2 Contact arrangement: A:1A;C:1C 3 Enclosure: S: Wash tight; Z: Flux proof 4 Contact rating: 12V:1A:35A/14VDC;1C:NO:35A/14VDC;NC:20A/14VDC 1A:40A/14VDC(Special clients) 24V:1A:15A,20A/28VDC; 1C:NO:15A/28VDC; NC:10A/28VDC	5 Coil rated voltage(V): DC:12,24 6 Coil transient suppression: NIL:standard R:with resistor D:with diode	

Contact Data			
Contact Arrangement	1A(SPSTNO) 1C(SPDT(B-M))		
Contact Material	AgSnO ₂		
Contact Rating	Coil rated voltage	1A	1C
	12V	35A/14VDC, 40A/14VDC	NO:35A/14VDC NC:20A/14VDC
	24V	15A/28VDC, 20A/28VDC	NO:15A/28VDC NC:10A/28VDC
Max. Switching Power	560W		
Max. Switching Voltage	30VDC	Max. Switching Current:40A	
Voltage Drop(Intial)	Typ.: 50mV(at10A)	Item 4.12 of IEC 61810-7	
Electrical Endurance	1×10 ⁵	Item 4.30 of IEC 61810-7	
Mechanical Endurance	1×10 ⁷	Item 4.31 of IEC 61810-7	

Coil Parameter		Coil voltage VDC		Coil resistance Ω±10%		With Suppression Rstive	Pick-up voltage VDC(max) (65%of rated voltage)	Drop-out voltage VDC(min) (10% of rated voltage)	Coil power W	Operate time ms	Release time ms
Dash numbers	Rated	Max.	Without Rstive	With Rstive							
			012-1500	12	16	96	84	680	7.8	1.2	1.5
024-1800	24	32	320	286	2700	15.6	2.4	1.8	≤10	≤10	

Notes: 1.The use of any coil voltage less than the rated coil voltage will compromise the operation of the relay.
 2.Pick-up and drop-out voltage are for test purposes only and are not to be used as design criteria.

Characteristics

Insulation Resistance	100MΩ min (at 500VDC)	Item 4.11 of IEC 61810-7
Dielectric Strength Between Contacts Between Contact and Coil	500VAC 1min 500VAC 1min	Item 4.9 of IEC 61810-7
Shock Resistance	Functional:98m/s ² 11ms	Item 4.26 of IEC 61810-7
	Destructive:980m/s ² 11ms	
Vibration Resistance	Functional:10Hz~55Hz Double amplitude 1.5mm	Item 4.28 of IEC 61810-7
	Destructive:10Hz~55Hz Double amplitude 1.5mm	
Terminals Strength	Terminal retention(pull & push): ≥100N Terminal resistance to bending(front & side): ≥10N	Item 4.24 of IEC 61810-7
Ambient Temperature	-40°C~125°C	
Relative Humidity	5% to 85%	Item 4.16 of IEC 61810-7
Weight (Approx.)	18g	Item 4.7 of IEC 61810-7

Dimensions

mm

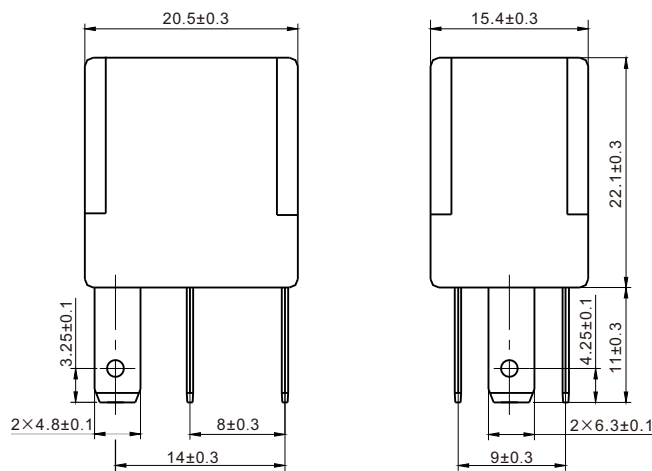

Dimensions

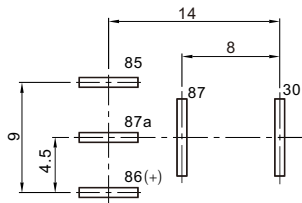

Note: 1A without 87a

Mounting (Bottom view)

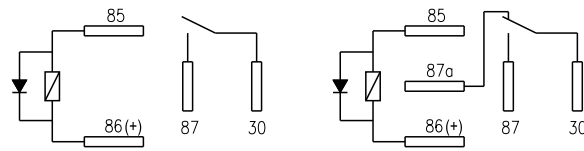

1A

1C

Wiring diagram (Bottom view)

Remark: In case of no tolerance shown in outline dimension: outline dimension ≤1mm, tolerance should be ±0.2mm ;
outline dimension >1mm and ≤5mm, tolerance should be ±0.3mm; outline dimension >5mm, tolerance should be ±0.4mm.

Reference Data

Coil Temperature Rise (Contact Rating 12V)

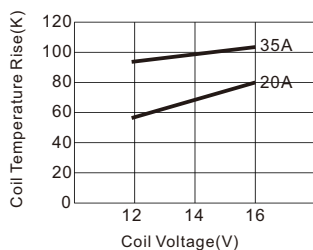

Coil Temperature Rise (Contact Rating 24V)

