



23.6×13.2×9.9

NV231

Features

- Small size, light weight (8g) .
- Withstands high temperature, operating under 105°C ambient temperature.
- Heavy contact load switching current up to 30A.
- Suitable for automobile and lamp accessories application.

Ordering Information

NV231 2C Z 0.57 DC12V 30

1 2 3 4 5 6

1 Part number: NV231

2 Contact arrangement: 2A(Twin); 2C(Twin)

3 Enclosure: S: Wash tight; Z: Flux proof

4 Coil power: 0.55:0.55W; 0.57:0.57W

5 Coil rated voltage(V): DC:10,12,24

6 Contact current: 30:30A; 20:20A

Contact Data

Contact Arrangement	2A(DPSTNO)(Twin) 2C(DPDT(B-M))(Twin)	
Contact Material	AgSnO ₂	
Contact Rating	NO:30A/14VDC; NC:25A/14VDC NO:20A/14VDC; NC:15A/14VDC	
Max. Switching Power	420W	
Max. Switching Voltage	24VDC	Max. Switching Current:30A
Voltage Drop(Initial)	Typ.: 50mV(at 10A)	Item 4.12 of IEC 61810-7
Electrical Endurance	1×10 ⁵	Item 4.30 of IEC 61810-7
Mechanical Endurance	1×10 ⁷	Item 4.31 of IEC 61810-7

Coil Parameter

Dash numbers	Coil voltage VDC		Coil resistance Ω ±10%	Pick-up voltage VDC(max) (58%of rated voltage)	Drop-out voltage VDC(min) (12.5% of rated voltage)	Coil power W	Operate time ms	Release time ms
	Rated	Max.						
010-550	10	12	2×181	5.8	1.25	2×0.55	≤4	≤1.5
012-570	12	14.4	2×254	7.0	1.5	2×0.57	≤4	≤1.5
024-570	24	28.8	2×1010	13.9	3			

Notes: 1.The use of any coil voltage less than the rated coil voltage will compromise the operation of the relay.
2.Pick-up and drop-out voltage are for test purposes only and are not to be used as design criteria.

Characteristics

Insulation Resistance	1000MΩ min (at 500VDC)	Item 4.11 of IEC 61810-7
Dielectric Strength Between Contacts Between Contact and Coil	500VAC 1min 500VAC 1min	Item 4.9 of IEC 61810-7
Shock Resistance	294m/s ² 6ms	Item 4.26 of IEC 61810-7
Vibration Resistance	10Hz~500Hz Double amplitude 1.27mm 60m/s ²	Item 4.28 of IEC 61810-7
Terminals Strength	10N	Item 4.24 of IEC 61810-7
Ambient Temperature	-40℃~105℃	
Relative Humidity	5% to 85%	Item 4.16 of IEC 61810-7
Weight (Approx.)	8g	Item 4.7 of IEC 61810-7

Dimensions

mm

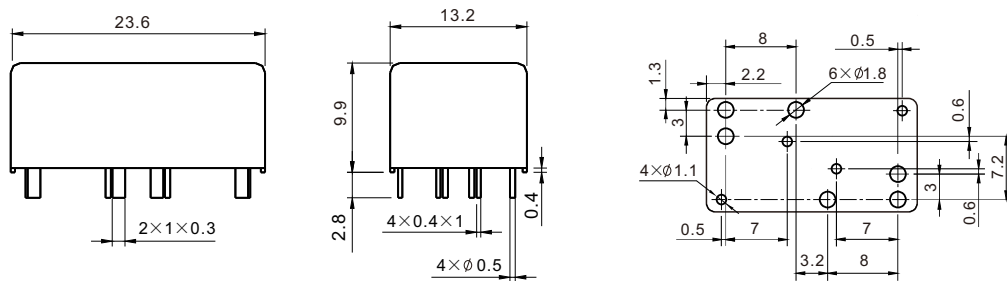

Dimensions

Mounting (Bottom view)

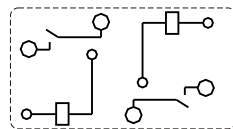

2A

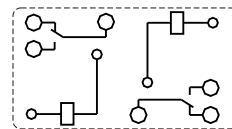

2C

Wiring diagram (Bottom view)

Remark: In case of no tolerance shown in outline dimension: outline dimension ≤ 1mm, tolerance should be ±0.2mm ;
outline dimension > 1mm and ≤ 5mm, tolerance should be ±0.3mm; outline dimension > 5mm, tolerance should be ±0.4mm.